

FITTING INSTRUCTIONS – NOTICE DE POSE – MONTAGE HANDLEIDING – MONTAGEANLEITUNG

ISTRUZIONI DI MONTAGGIO – INSTRUCCIONES DE MONTAJE

### System Specification

**Maximum Door Width** = 1200mm

**Minimum Door Width** = 500mm

**Husky Door Range** = 32 to 47mm

**Soltaire Door range** = 35 to 47mm

**Maximum Husky Panel Weight** = 80kg

**Maximum Soltaire Panel Weight** = 120kg

### Contents of Kit

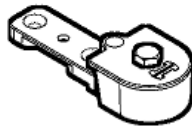

2 x Short Arm

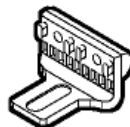

4 x Belt joint



4 x Belt retain



10 x Belt clamp

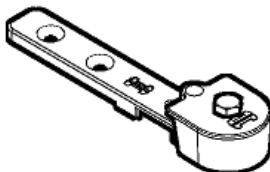

2 x Long arm



2 x Fixed floor  
guide



2 x Adjustable  
floor guide



2 x Adjustable floor  
guide bracket

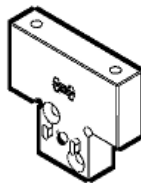

2 x Datum Block



Toothed belt (Metres)  
x 16 m

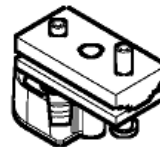

2 x Universal tension  
block

	UTEL/4
M6 x 12 CSK HD	10
10G x 30 Woodscrews	26
M4 x 6 Grubscrew	2
M6 x 10 Hex HD Bolt	8

## PLEASE NOTE

These instructions are to be read in conjunction with instructions specific to your chosen system.

Remember to install track stops into track; these are used to limit the travel of the doors.

### Tools required



Tape  
Measure



2, 4 & 5 mm  
Allen keys



Posi head  
screwdriver

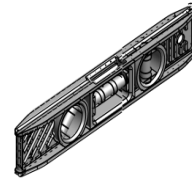

Spirit level



Scissors

### System overview & track installation

#### Husky End Elevation

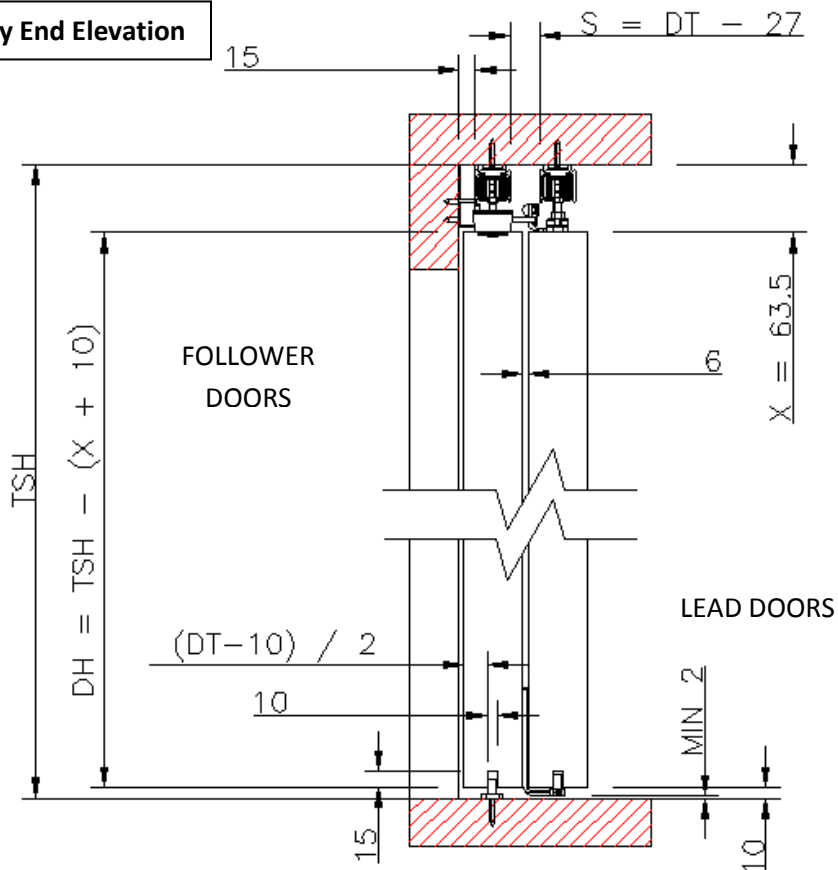

#### KEY

DT = DOOR THICKNESS

TSH = TRACK SET HEIGHT

DH = DOOR HEIGHT

S = GAP REQUIRED  
BETWEEN TRACKS

X = PCH RECOMMENDED  
TOP CLEARANCE (63.5mm)

## Soltaire End Elevation

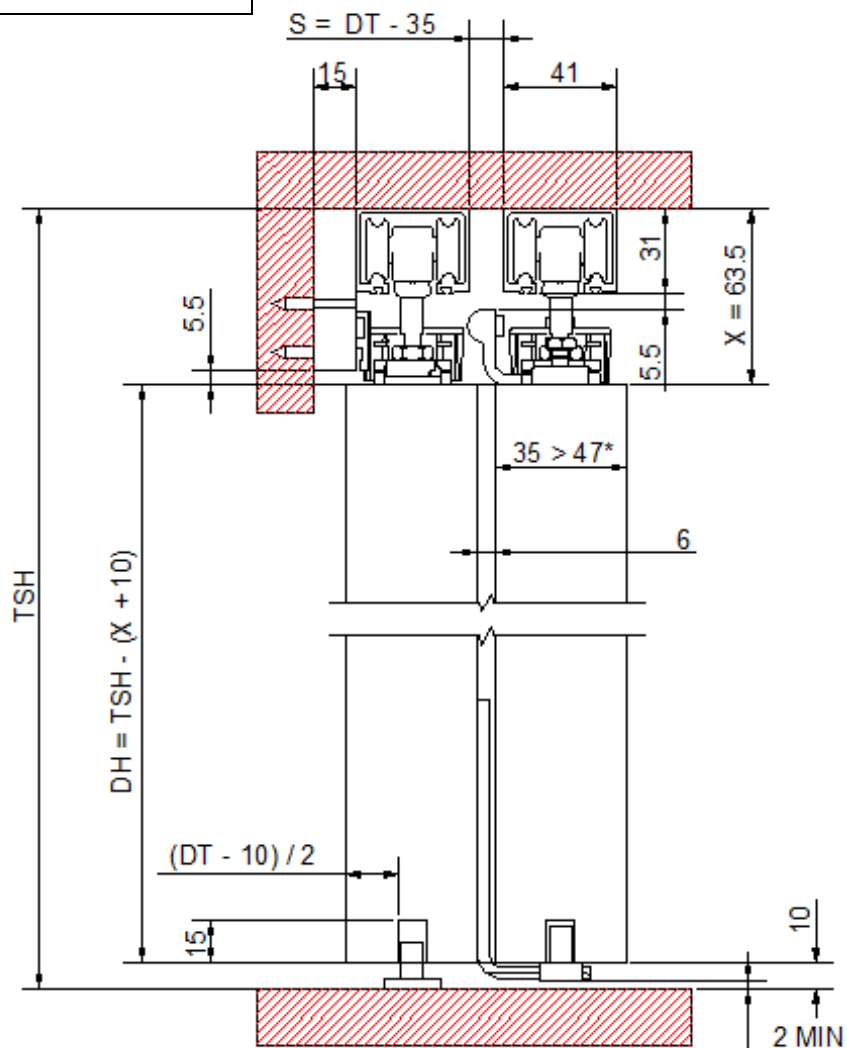

### KEY

DT = DOOR THICKNESS

TSH = TRACK SET HEIGHT

DH = DOOR HEIGHT

S = GAP REQUIRED BETWEEN TRACKS

X = PCH RECOMMENDED TOP CLEARANCE (63.5mm)

## Track Components (Husky shown)

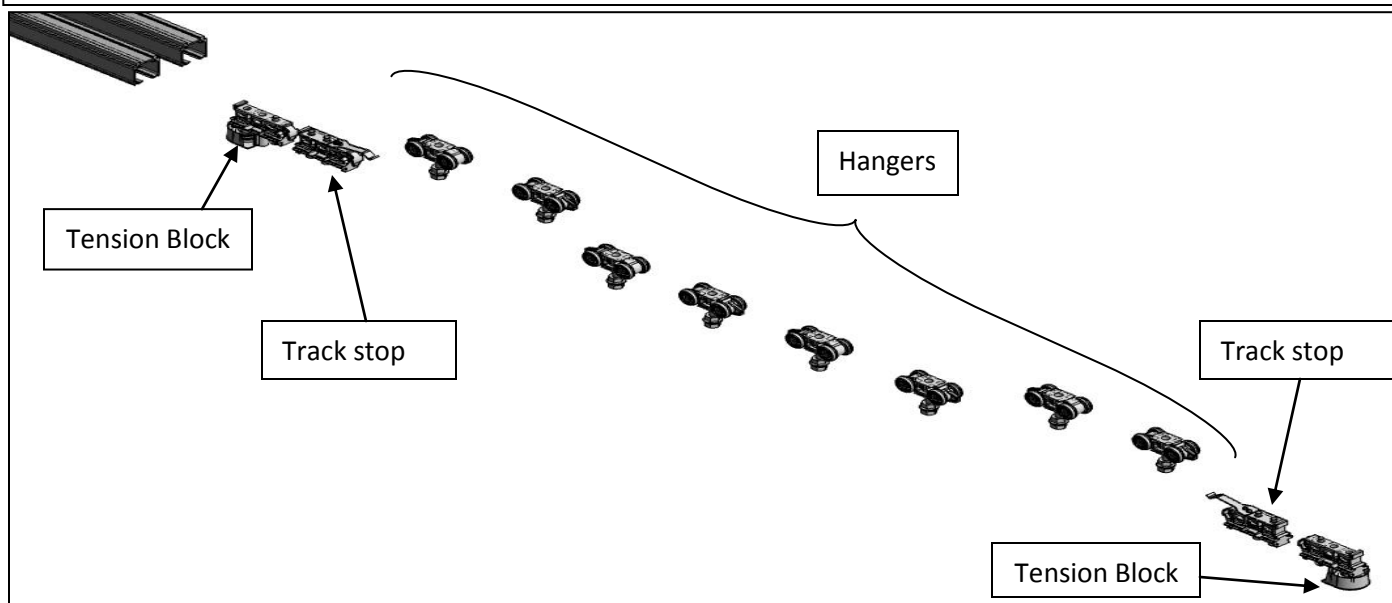

## Component Overview

 Apron plate position

### Follower Doors

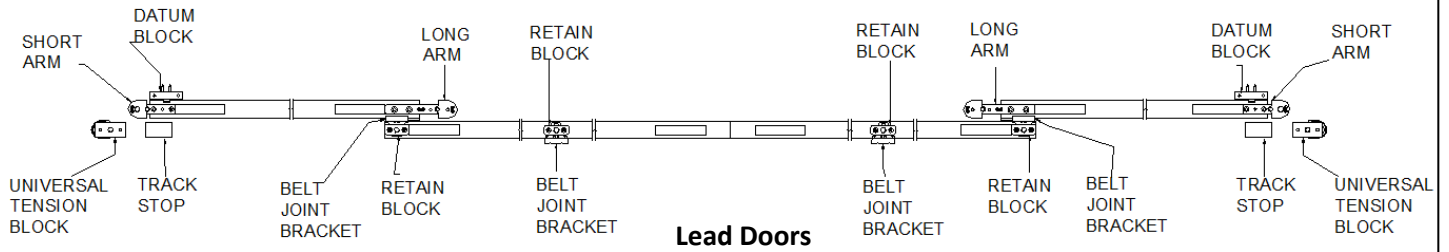

## Belt Position Overview

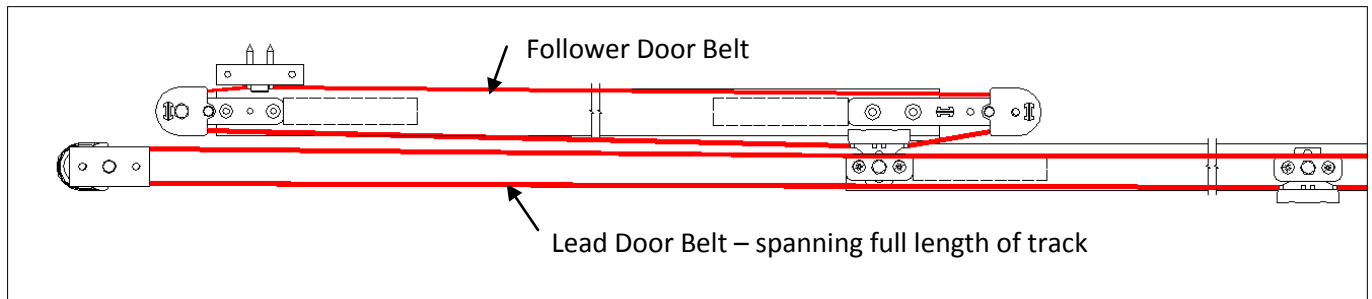
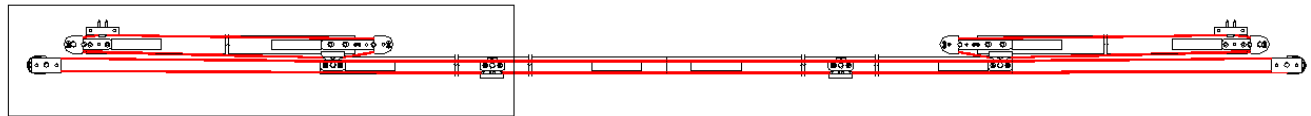

## Door component layout

### Door Position Overview

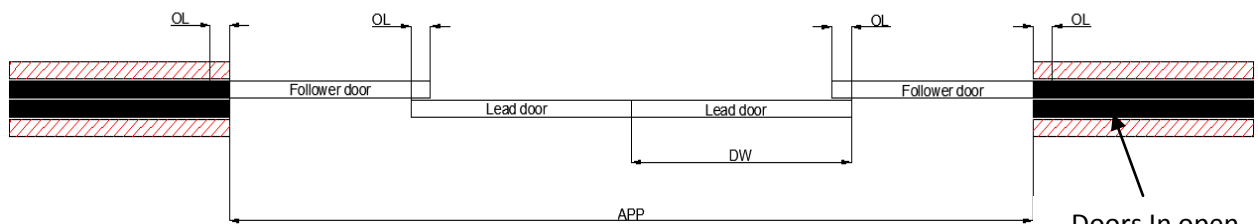

$$DW = \frac{4 \times OL + APP}{4}$$

4

PCH RECOMMEND OL = 70mm

Doors In open position

## KEY

DW = DOOR WIDTH

APP = MAXIMUM CLEAR OPENING WIDTH

OL = OVERLAP OF DOORS (RECOMMENDED 70mm)

## Door Floor guide routing detail

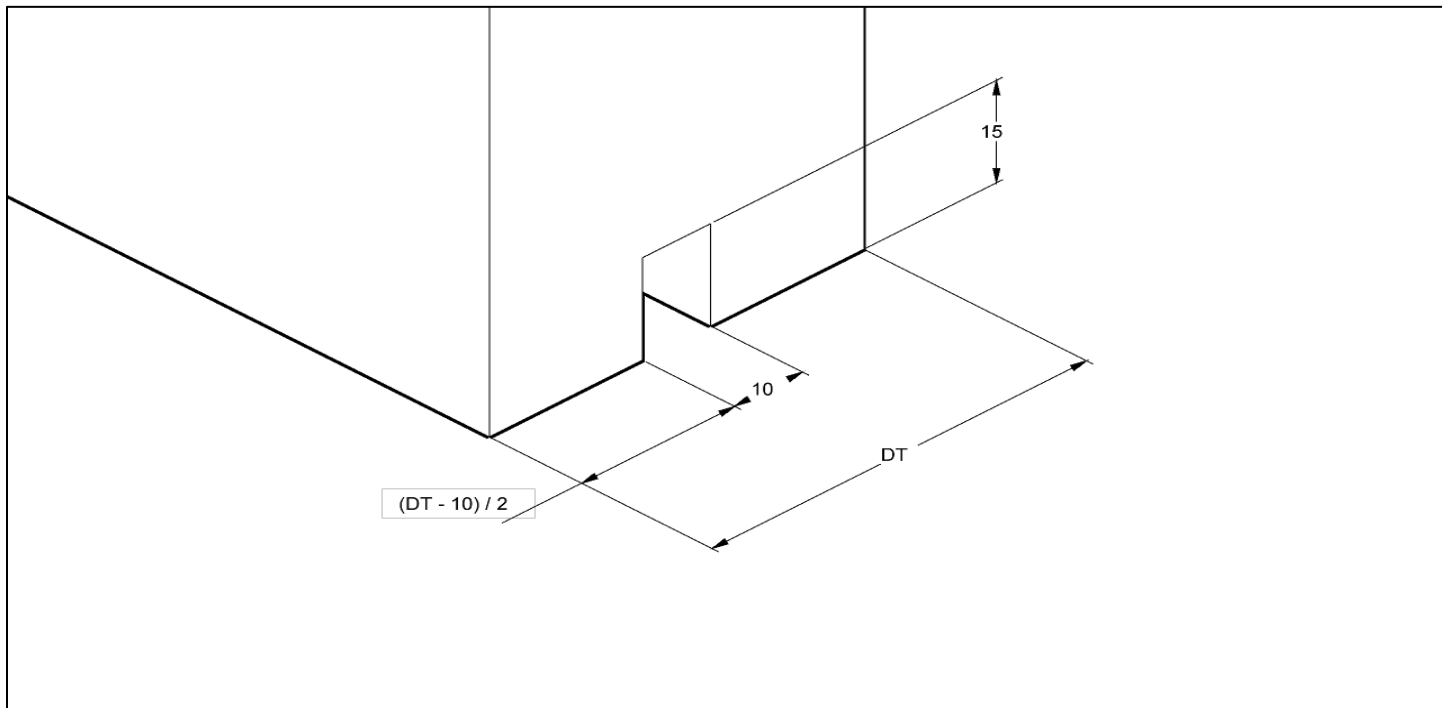

### 1. Attach Short arm on follower door

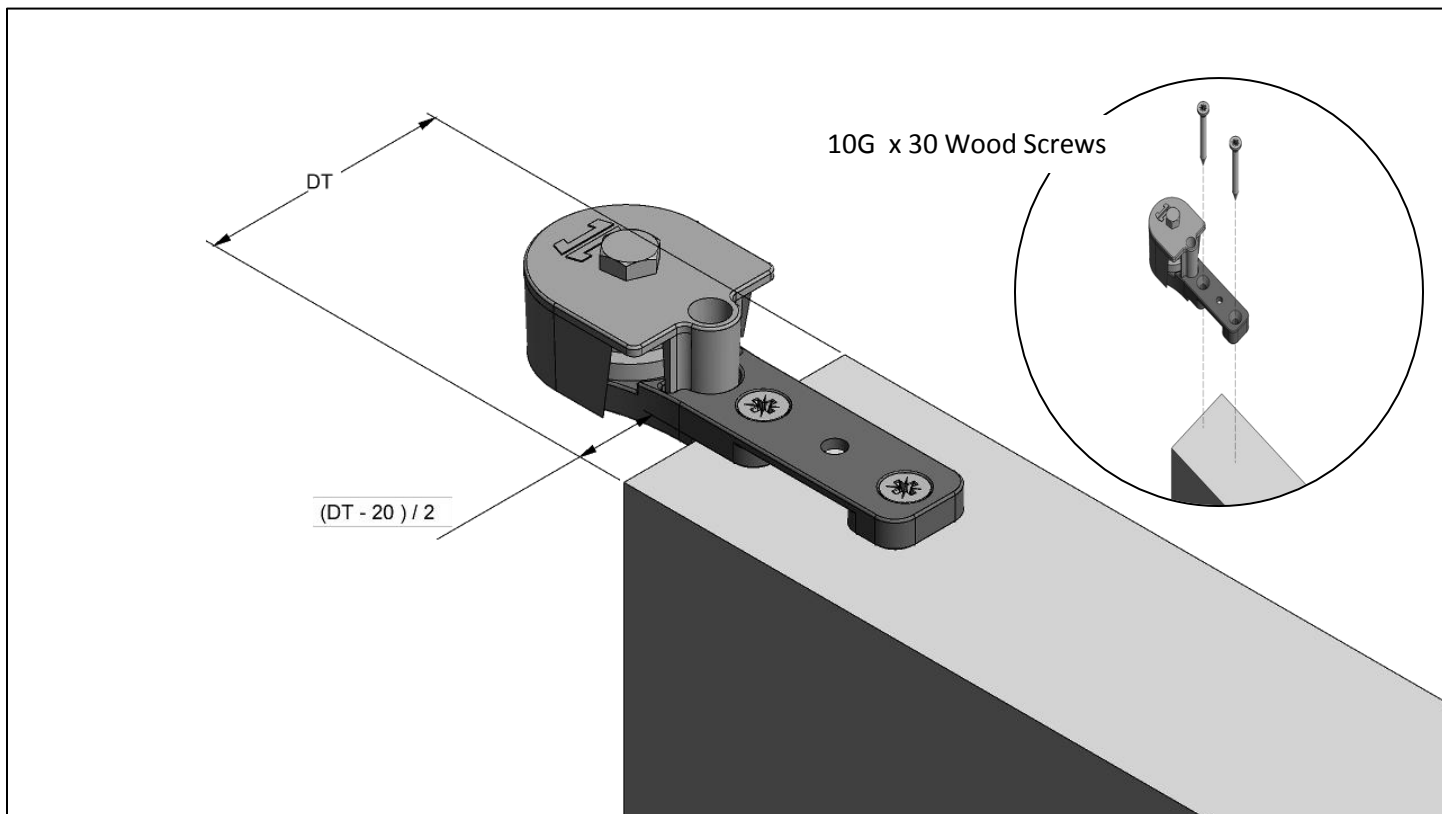

2. Attach Long arm on following doors

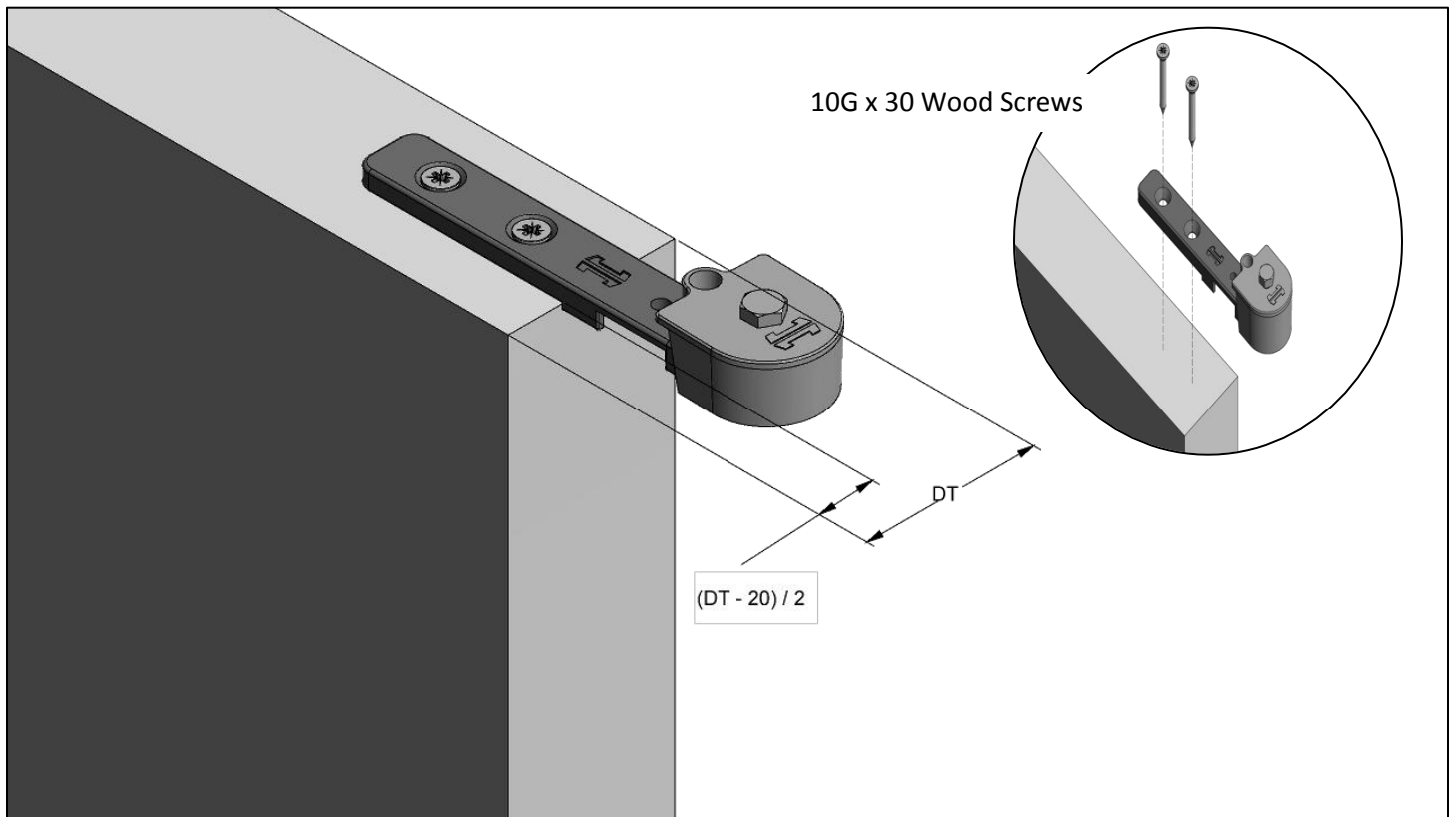

3. Remove bearing caps on follower doors

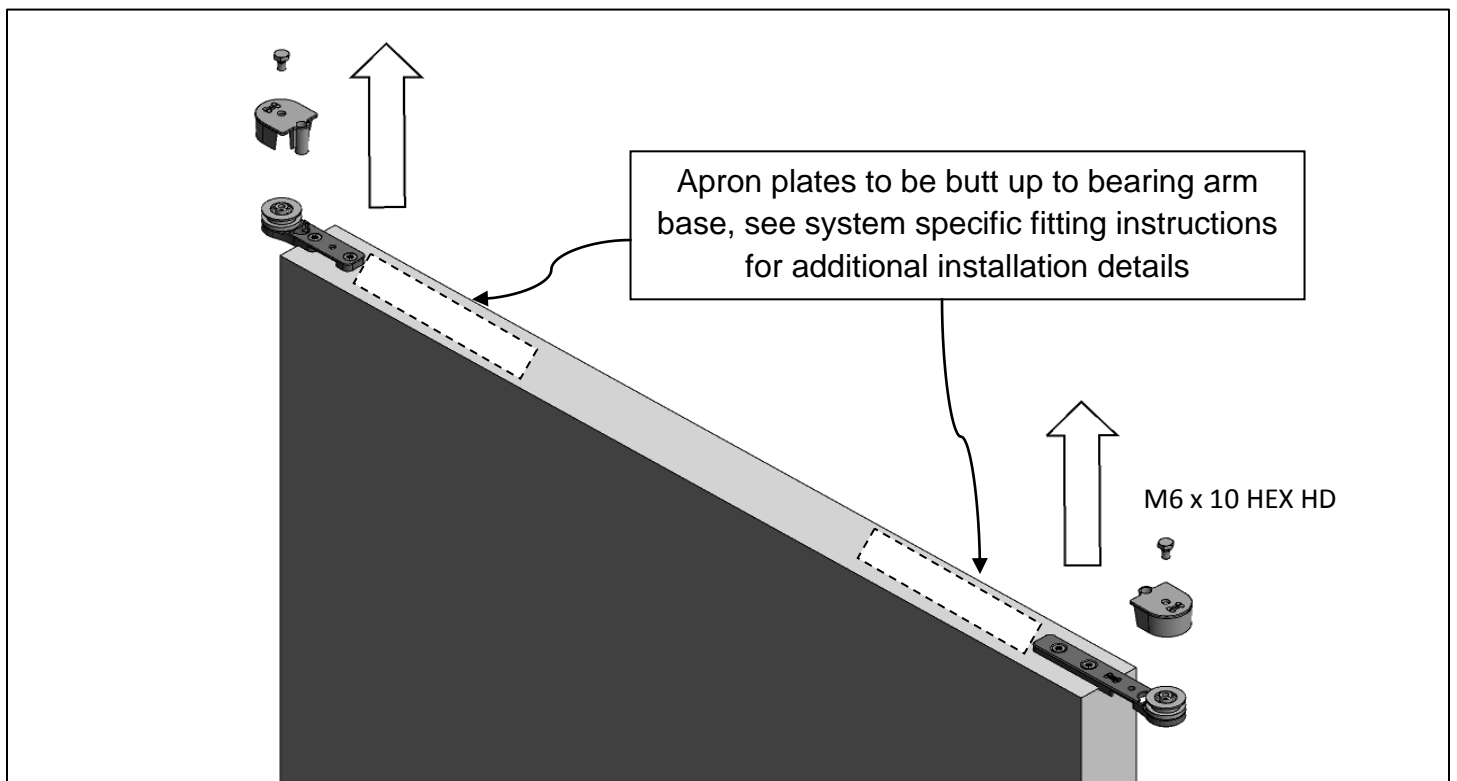

4. Loop belt around bearing wheels & cut belt to length – on follower doors

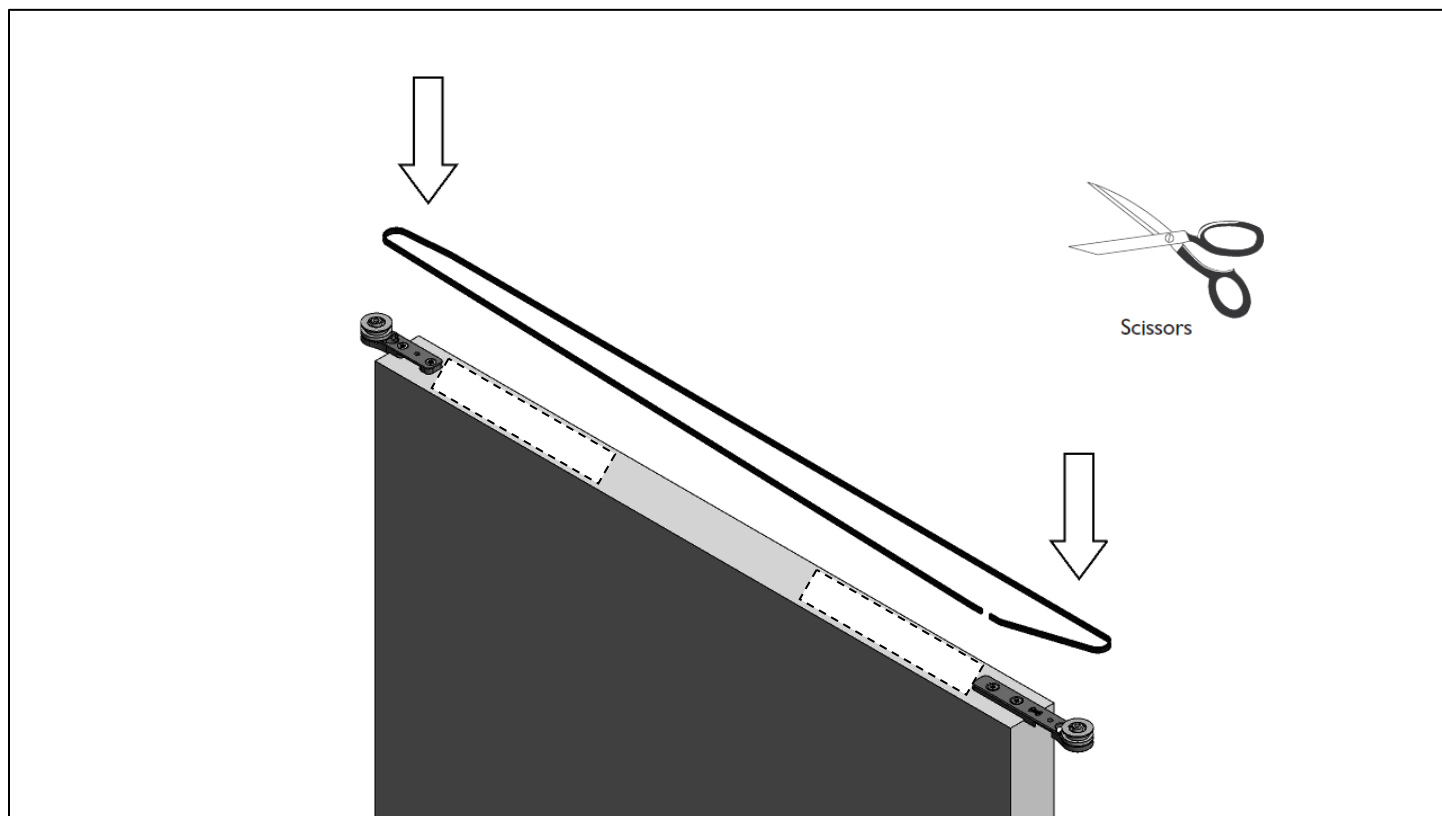

5. Attach both ends to belt joint bracket – on follower doors

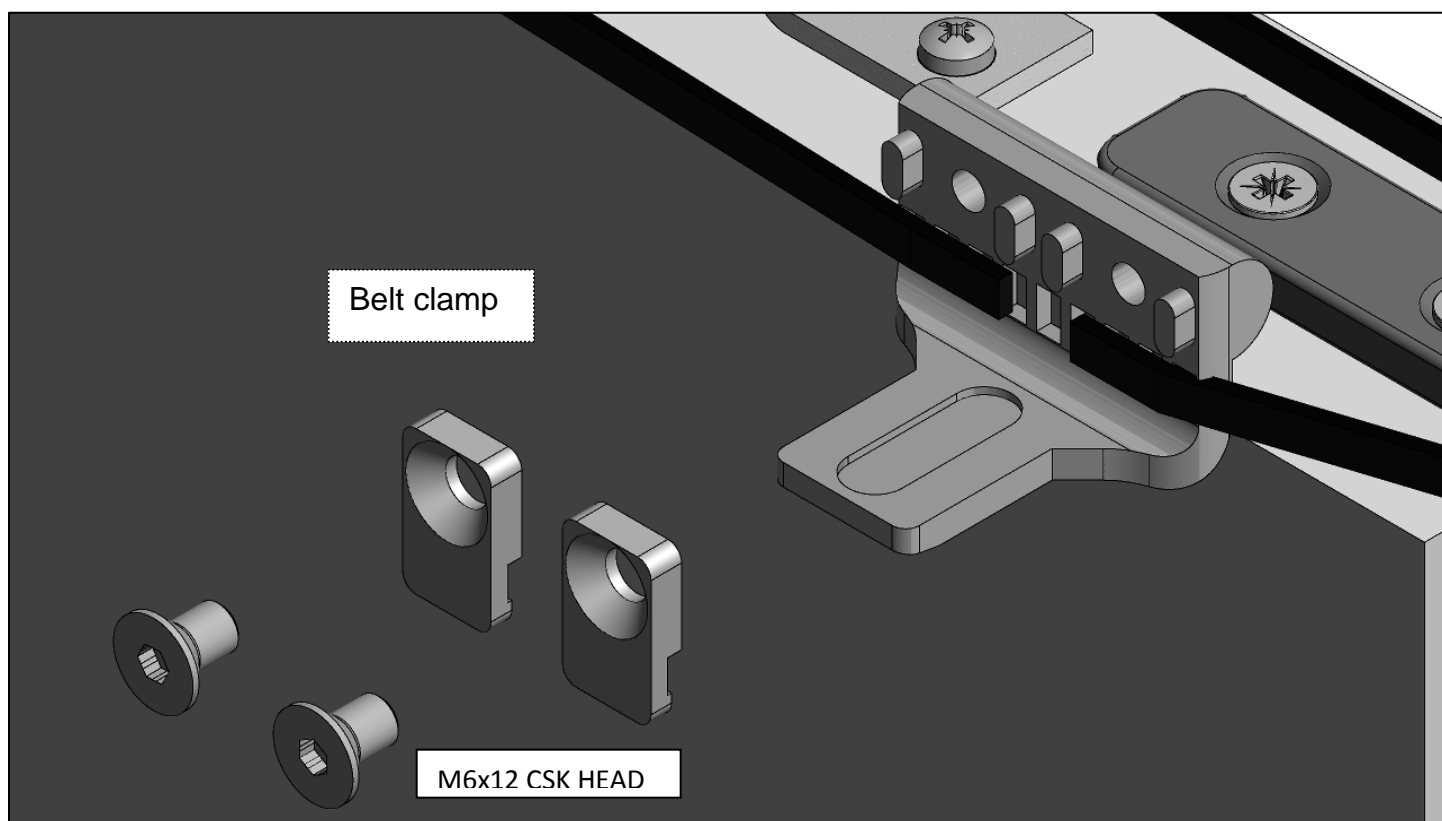

6. Clamp bracket should be free to traverse between bearings – on follower doors

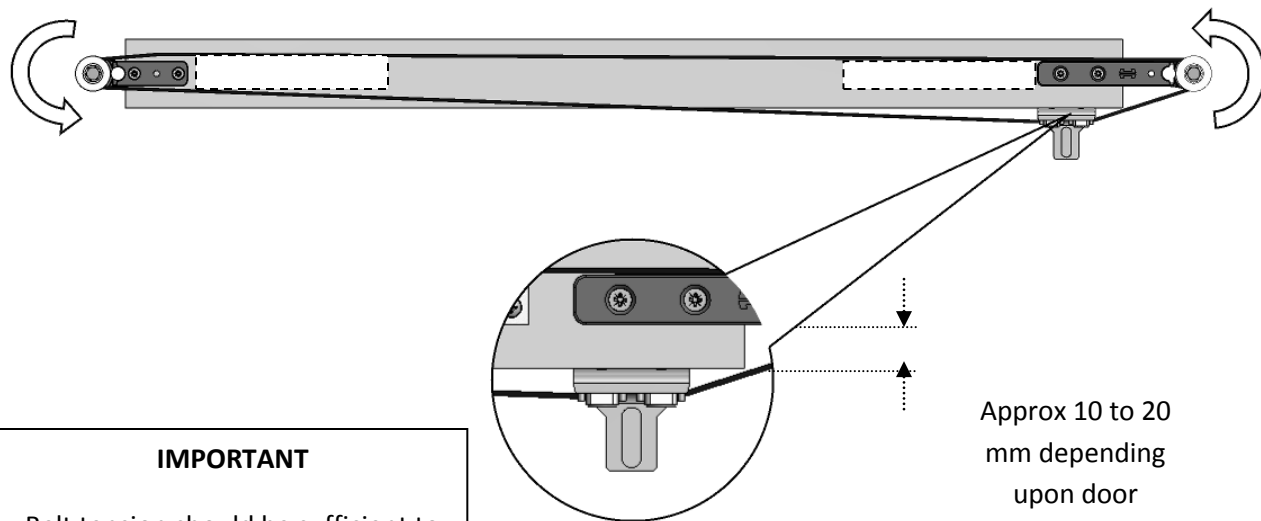

**IMPORTANT**

Belt tension should be sufficient to allow connection between doors

7. Re attach bearing caps

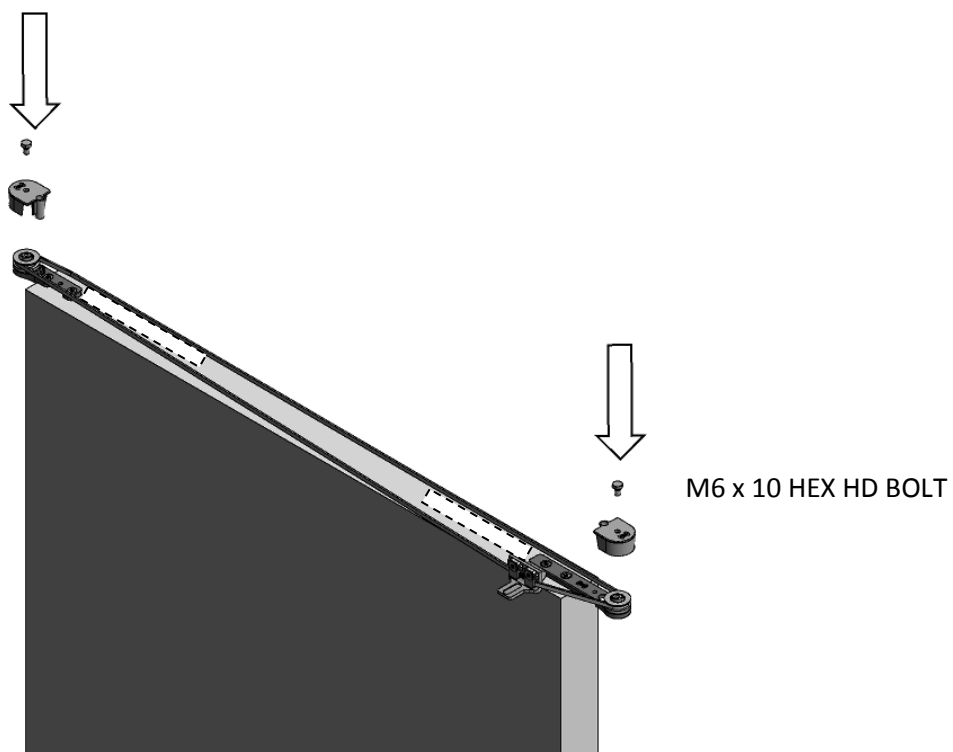



## 8. Position retain block on lead doors (LH lead door shown only)

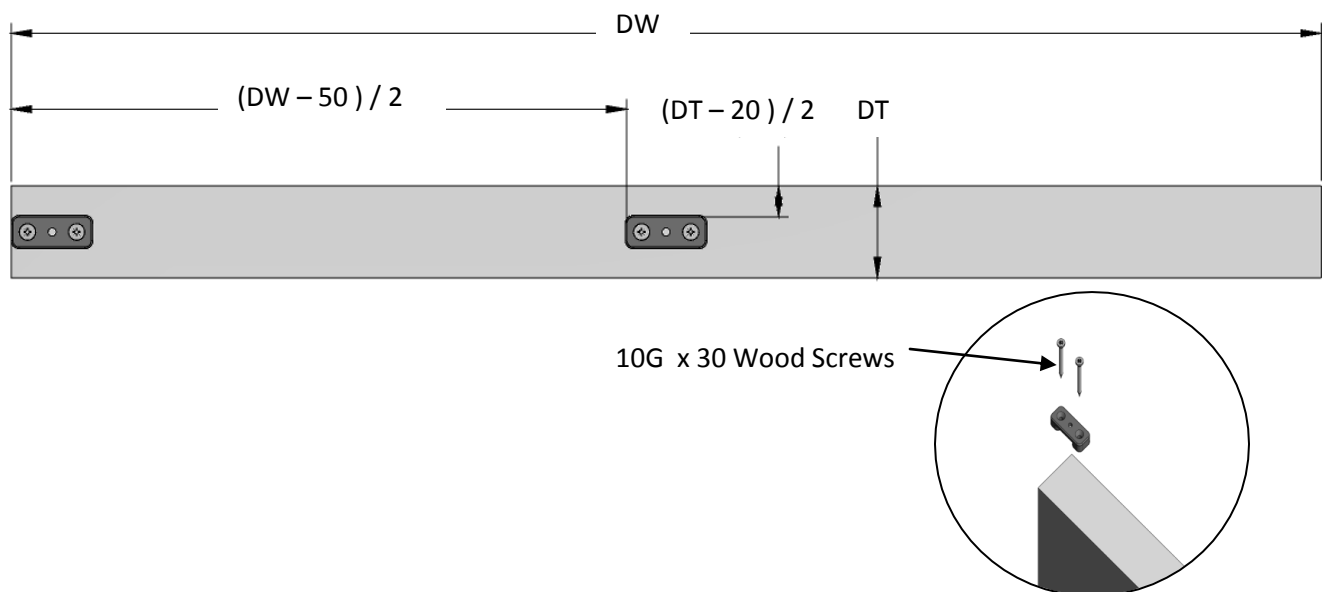

## 9. Floor guide overview

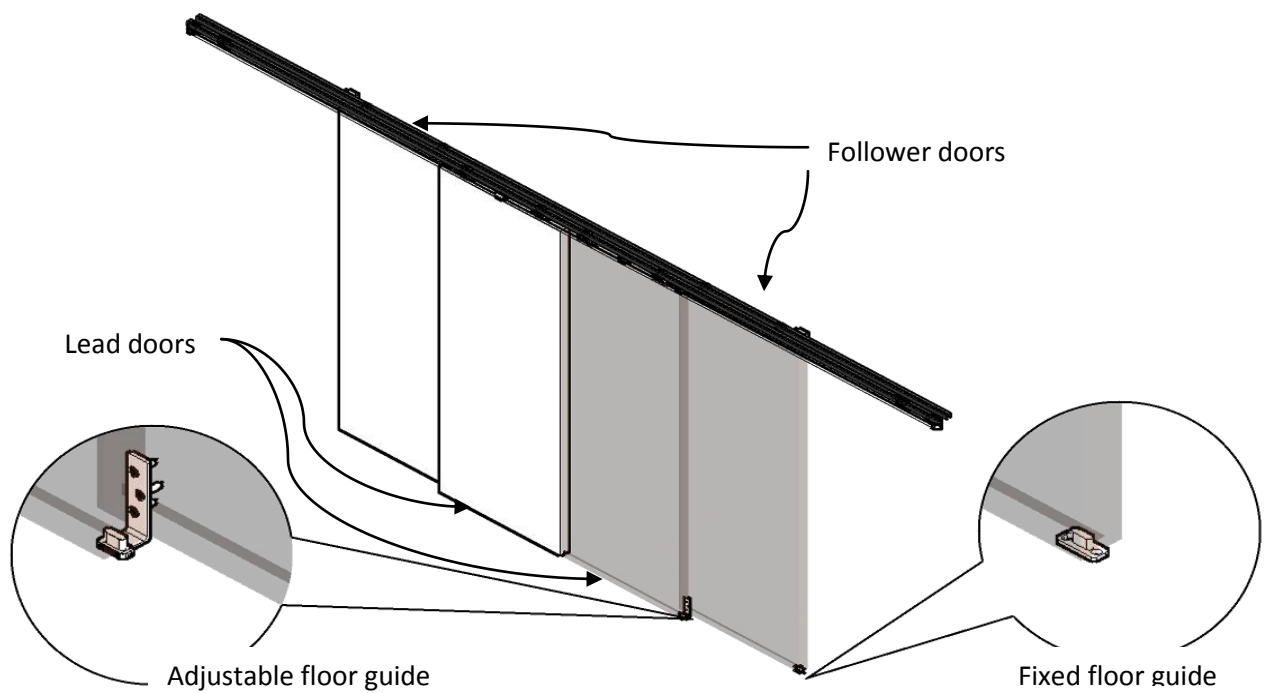

10. Position adjustable floor guide on face of follower door (LH door shown only)

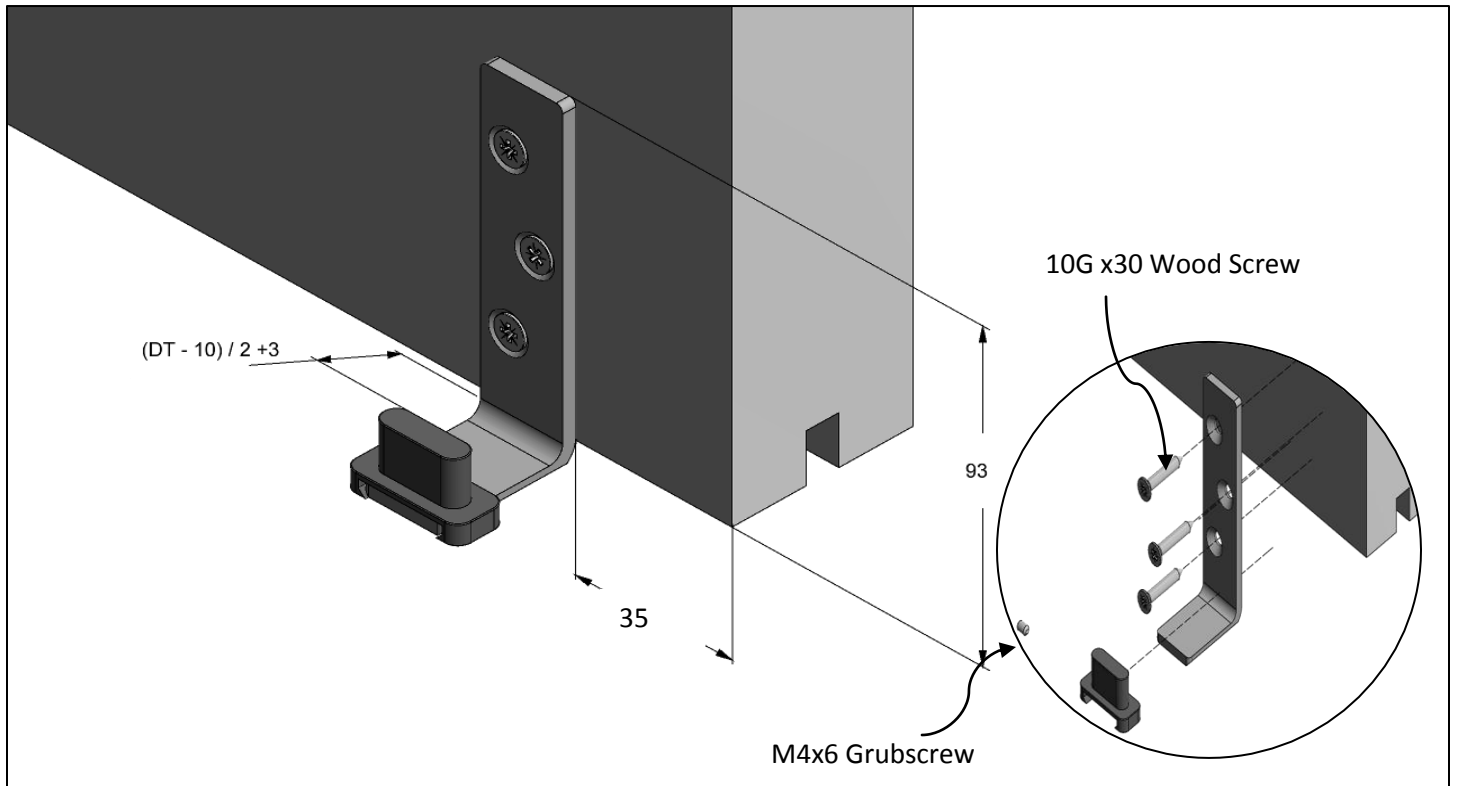

11. Hang Doors, Follow fitting instructions specific to your hanger

12. Ensure floor guide correctly aligned

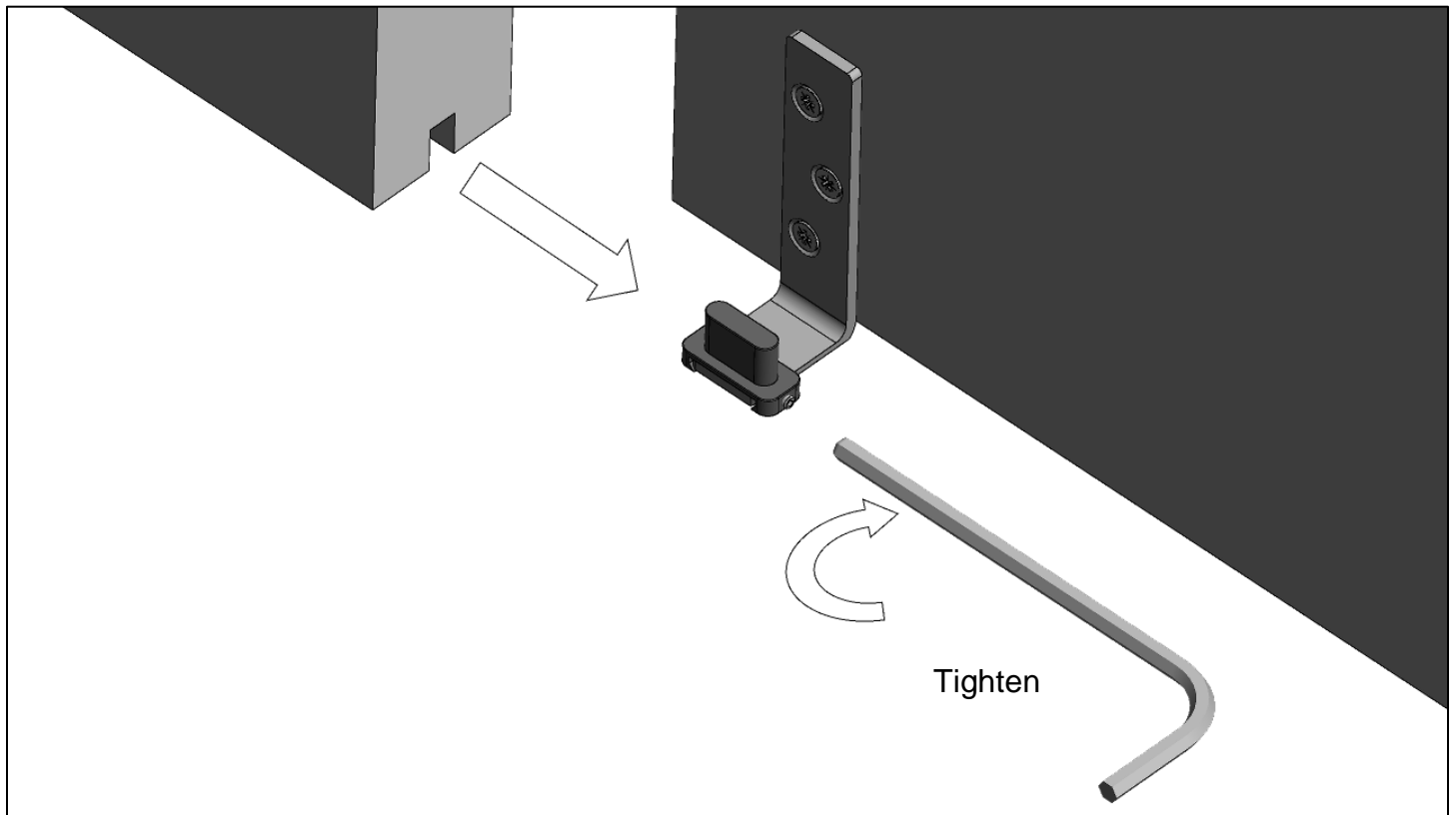

13. Align doors with spirit level & position fixed floor guides

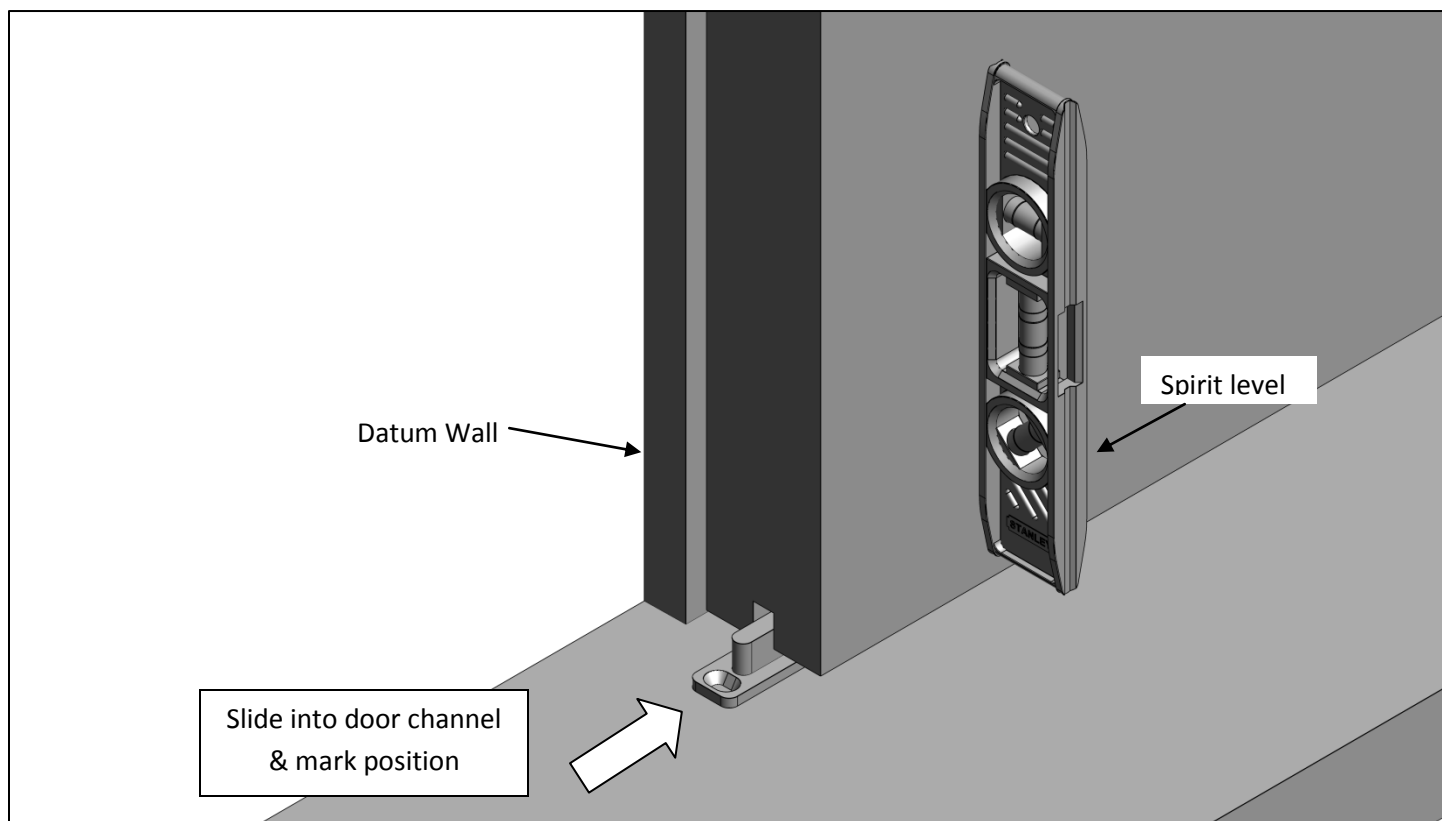

14a. Remove bearing cap from tension wheel assembly

14b. Loop belt around bearing wheels

**Husky Installation**

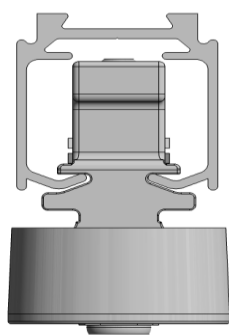

**Soltaire Installation**

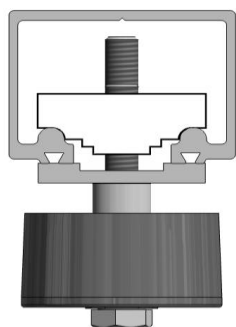

**14a.**

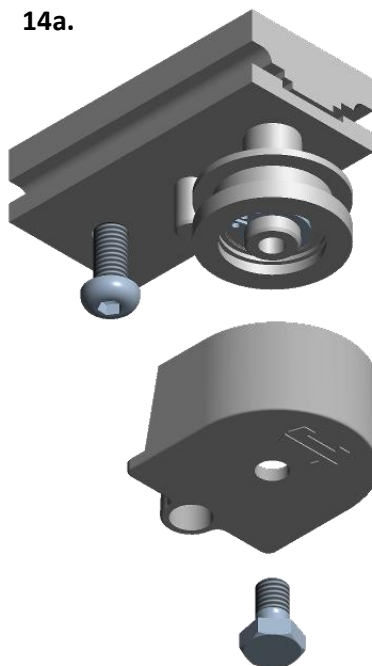

**14b.**

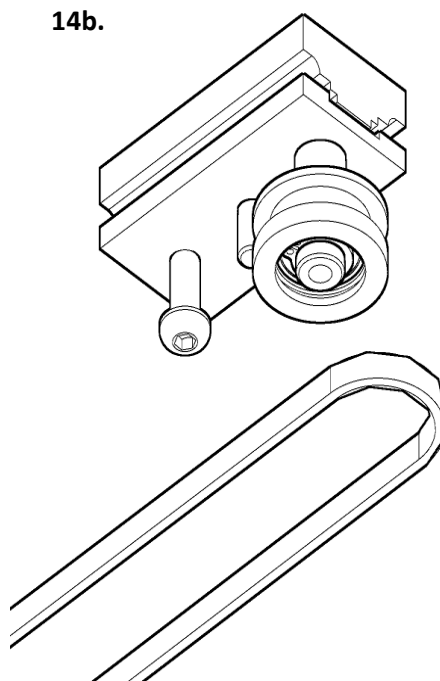

15. Re attach the bearing cover and apply tension to belt

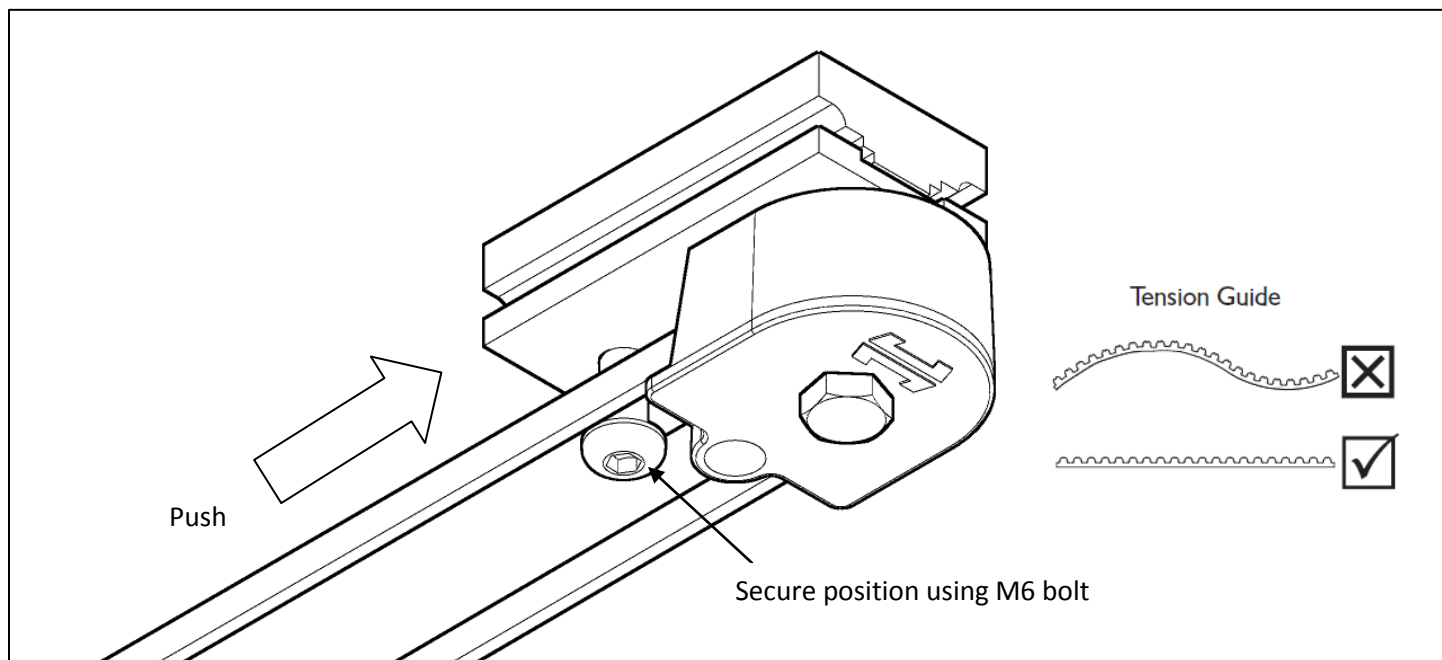

16. With Doors in Closed Position – Connect Follower Door to Lead Door

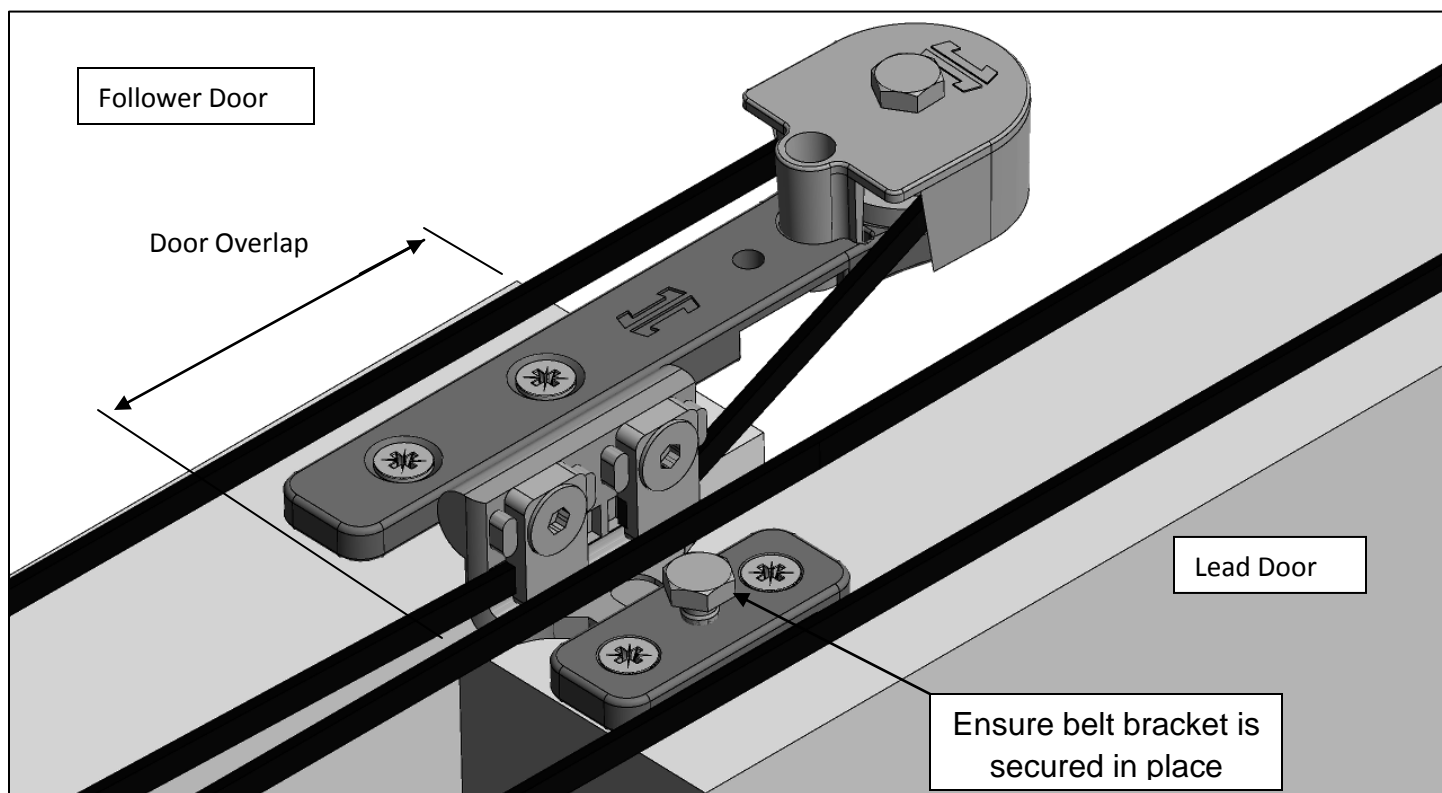

## 17. Door belt overview – Plan View

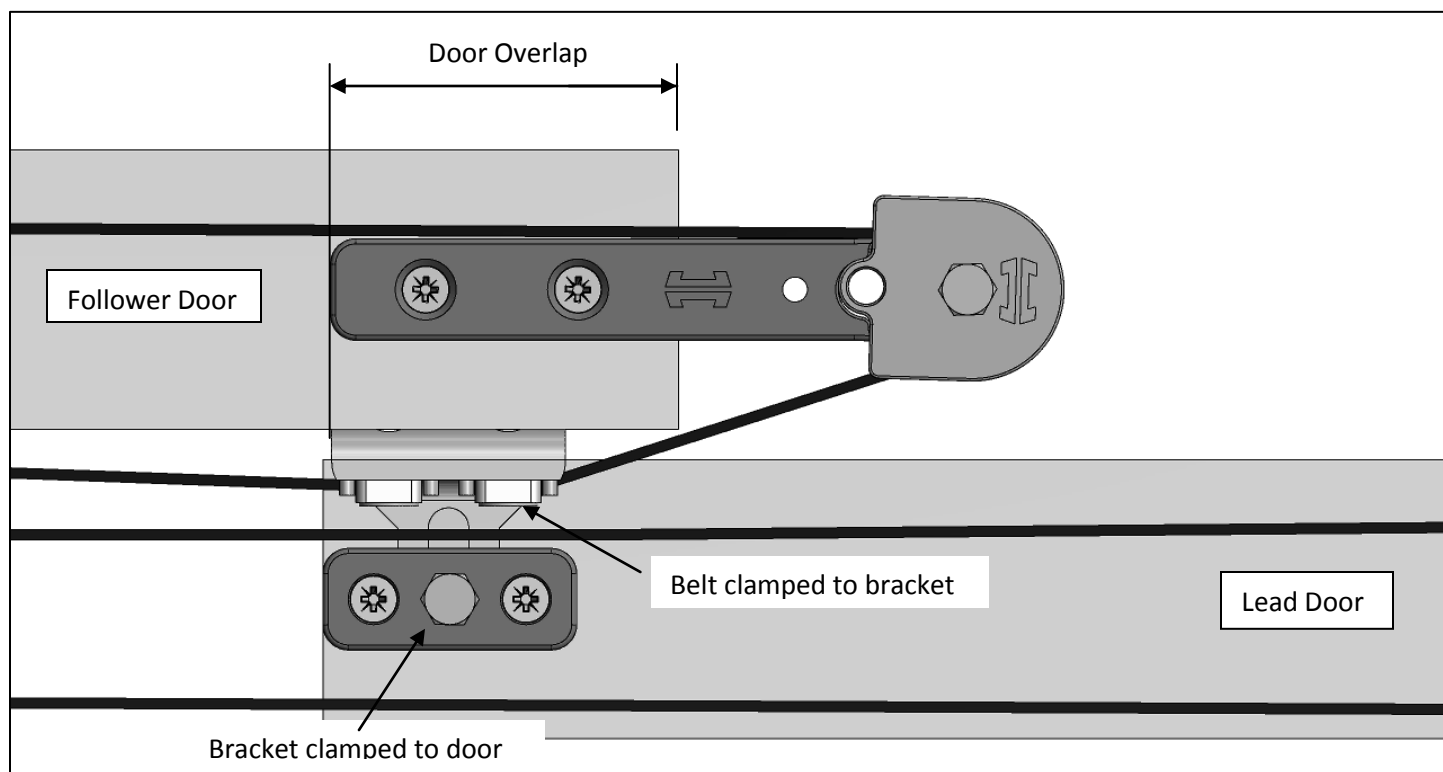

## 18. Connect Lead Door to Belt

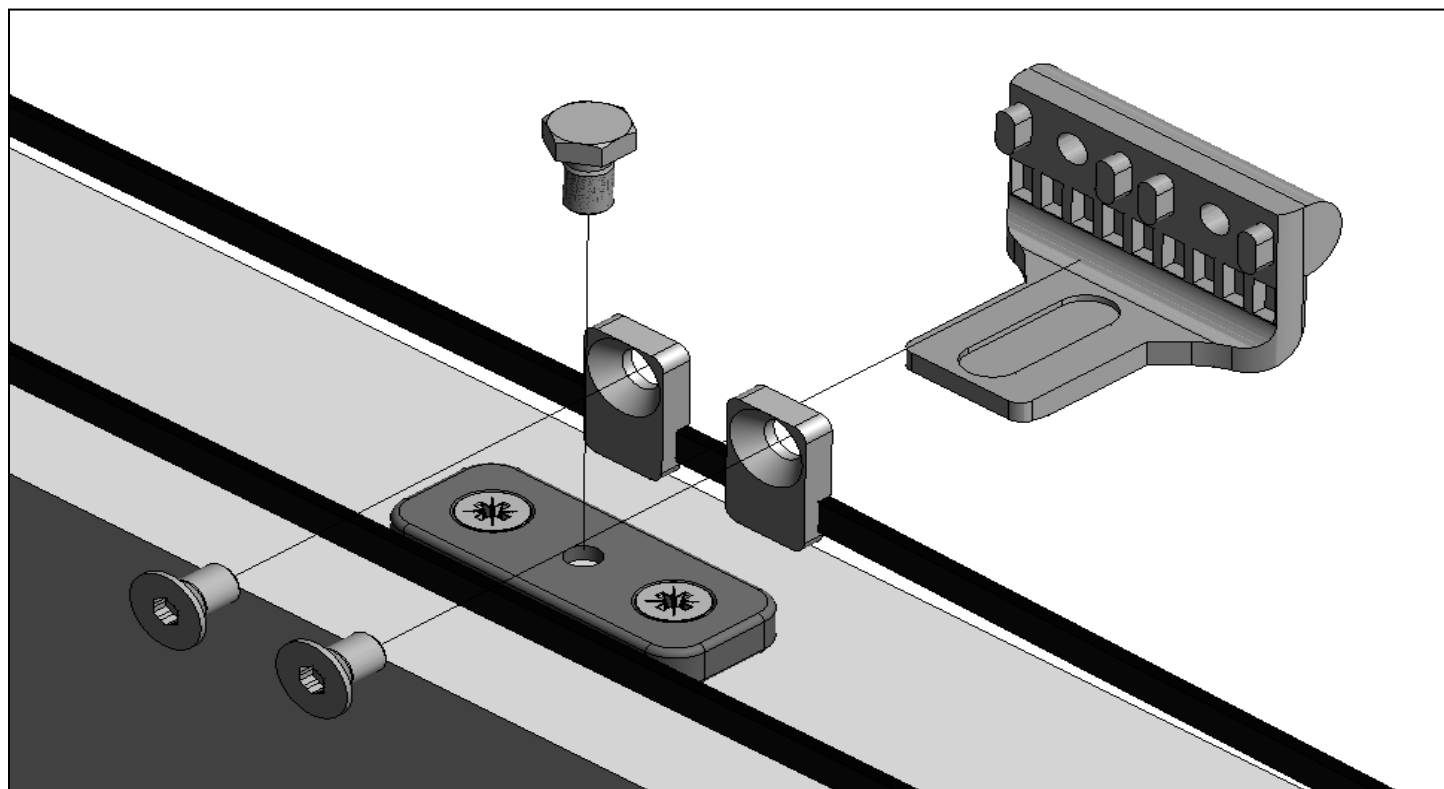

19. With doors fully closed mark position for datum block

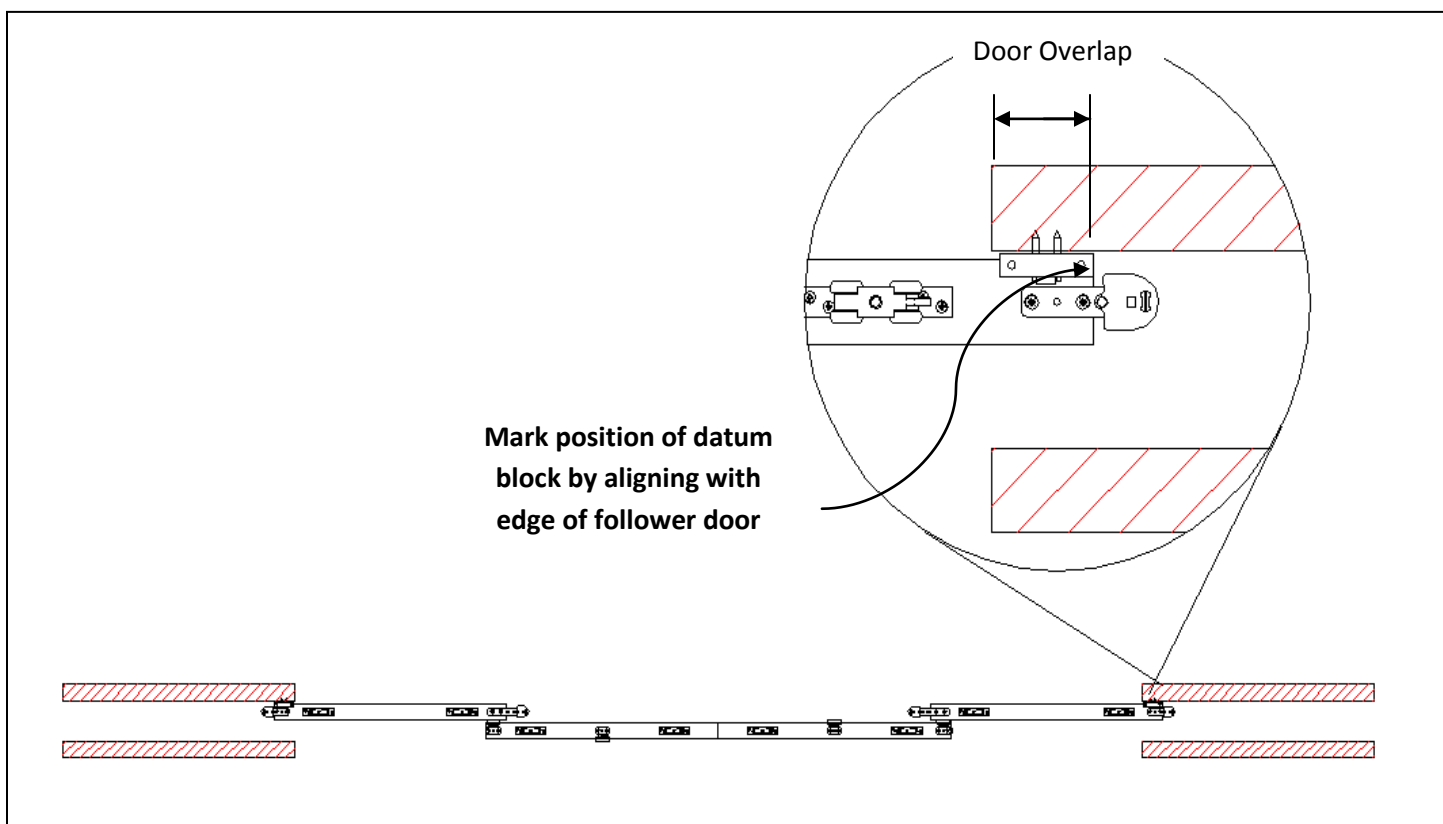

20. Affix datum block – ensuring doors are able to fully traverse the track

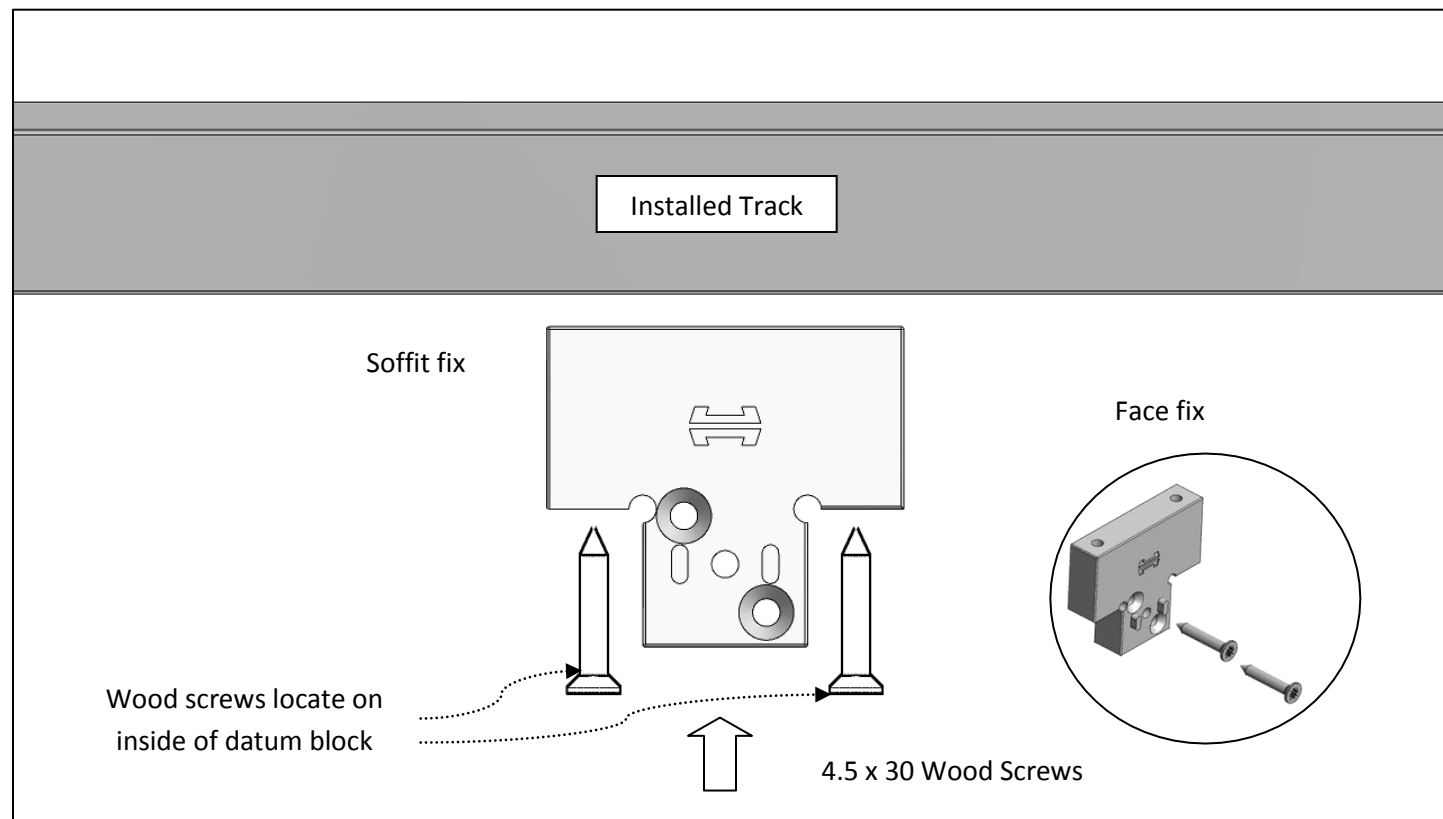

## 21. Connect belt to datum block

